

QF14 - Series Earth Leakages

The QF14 is a 6 kA earth leakage device, available as a circuit breaker as well as switch. It is grey in colour and can be mounted on a DIN rail. Its front escutcheon is 45 mm and fits on to most of the distribution boards for residential applications. It may be used in commercial and industrial applications, on panel boards to be fitted on a DIN rail.

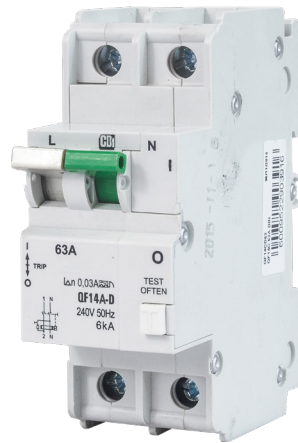

QF14AD
DIN Mount



QF14CD
DIN Mount

Features

- Hydraulic-magnetic technology
- 100% rated current capability, independent of ambient temperature
- VC 8035 compliant
- Ratings 6 to 63 A
- Earth leakage sensitivity 30 mA
- Single pole plus switched neutral earth leakage protection
- Precision tripping characteristics
- Trip indication with mid-trip position
- Can be switched on immediately after tripping
- Suitable to use for electrical isolation
- Surface and DIN rail mounting options, **45 mm** front escutcheon (**Grey**)

Applications

- Residential and commercial applications requiring high sensitivity earth leakage protection from electrical shock and fire hazards
- Telecom / datacom equipment
- Lighting control
- UPS equipment
- Alternative energy equipment
- Mobile power generation equipment
- Railway signalling equipment
- Industrial equipment

Approvals

VC 8035

Hydraulic-Magnetic Circuit Breakers 100% rated, unaffected by ambient temperature

QF14 - Series Earth Leakages

Technical Data

Product Type	QF14AD	QF14CD
Approvals	VC 8035	
Number of Poles	2 (1+N)	2 (1+N)
Standard Ampere Ratings	6 to 63 A	40 and 63 A
Rated Voltage	240 Vac	240 Vac
Sensitivity	30 mA	30 mA
Rated Interrupting/ Withstand Capacity	6 kA -	- 6 kA
Time Delay Curves	2	-

Product Type	QF14
Operating Temperature Range	-40 °C to +85 °C
Mounting Options	DIN mount
Time Delay Curves	2 (A version only)
Endurance	10000 operations - 1500 electrical at rated current and voltage
Dielectric Strength	1480 V (single pole) / 1830 V (multi pole), 50 Hz for one minute after testing
Weight	260 g (unpacked)
Altitude	Certification tests done at altitude ≈ 2000 metres. Will operate at higher altitudes.
Shock	16 G (IEC 600068-2-27)
Vibration	2 G (IEC 600068-2-27) (sinusoidal wave)
Flammability	I3 - Ignition does not persist at 850 °C after glow wire is withdrawn with an oxygen index of ≥ 28
Toxicity	F1 - Smoke index of ≤ 20 which determines the fume class
Pollution Degree	PD2 - Normally only non-conductive pollution occurs. Temporary conductivity caused by condensation is to be expected.

Earth Leakage	Wire Size (IEC)	Torque (IEC)	Comments
1+N	0.75 mm ² - 35 mm ²	2.5 N.m	Pz #2 Combi head

QF14 - Series Earth Leakages

Long Code

Example Code: Q-F-14-A--D-2-63A-30mA-240V

Group	1	2	3	4	5	6	7	8	9	10
Requirement	Q Frame	Type F	1 pole + N	Overload	No auxiliary switch	DIN mount	Medium delay curve 2	Current rating 63 A	Sensitivity 30 mA	Voltage 240 Vac
Long Code	Q	F	14	A	-	D	2	63A	30mA	240V

Ordering Information

Group 1: Frame Type	Code	Description	Comments
	Q	36 mm wide earth leakage	
Group 2: Product Type	Code	Description	Comments
	F	240 Vac, 6 kA	5 kA (VC 8035) / 6 kA
Group 3: No of Poles	Code	Description	Comments
	14	Single pole plus switched neutral (1+N)	QF14
Group 4: E-L Type	Code	Description	Comments
	A	Overload (auto tripping)	White and green handle
	C	Switch disconnecter / no overload	Green handle
Group 5: Auxiliary / Additional Pole	Code	Description	Comments
	-	Not applicable	
Group 6: Mounting	Code	Description	Comments
	D	DIN mount	DIN mount supplied in grey body only - 45 mm front escutcheon
Group 7: Time Delays	Code	Description	Comments
	2	Medium time delay	Standard
	3	Fast time delay	Special only
	9	Slow time delay	Special only
Group 8: Current Ratings	Code / Description		Comments
	6, 10, 16, 20, 25, 32, 40, 50, 63 A		QF14AD Ratings available vary depending on certification * Other ratings are available as special orders. Check availability.
	40, 63 A		QF14CD
Group 9: Sensitivity	Code	Description	Comments
	30mA	30 mA	Standard
Group 10: Voltage	Code	Description	Comments
	240 V	240 Vac	

For options not listed, please contact CBI

QF14 - Series Earth Leakages

Time Delay Curve

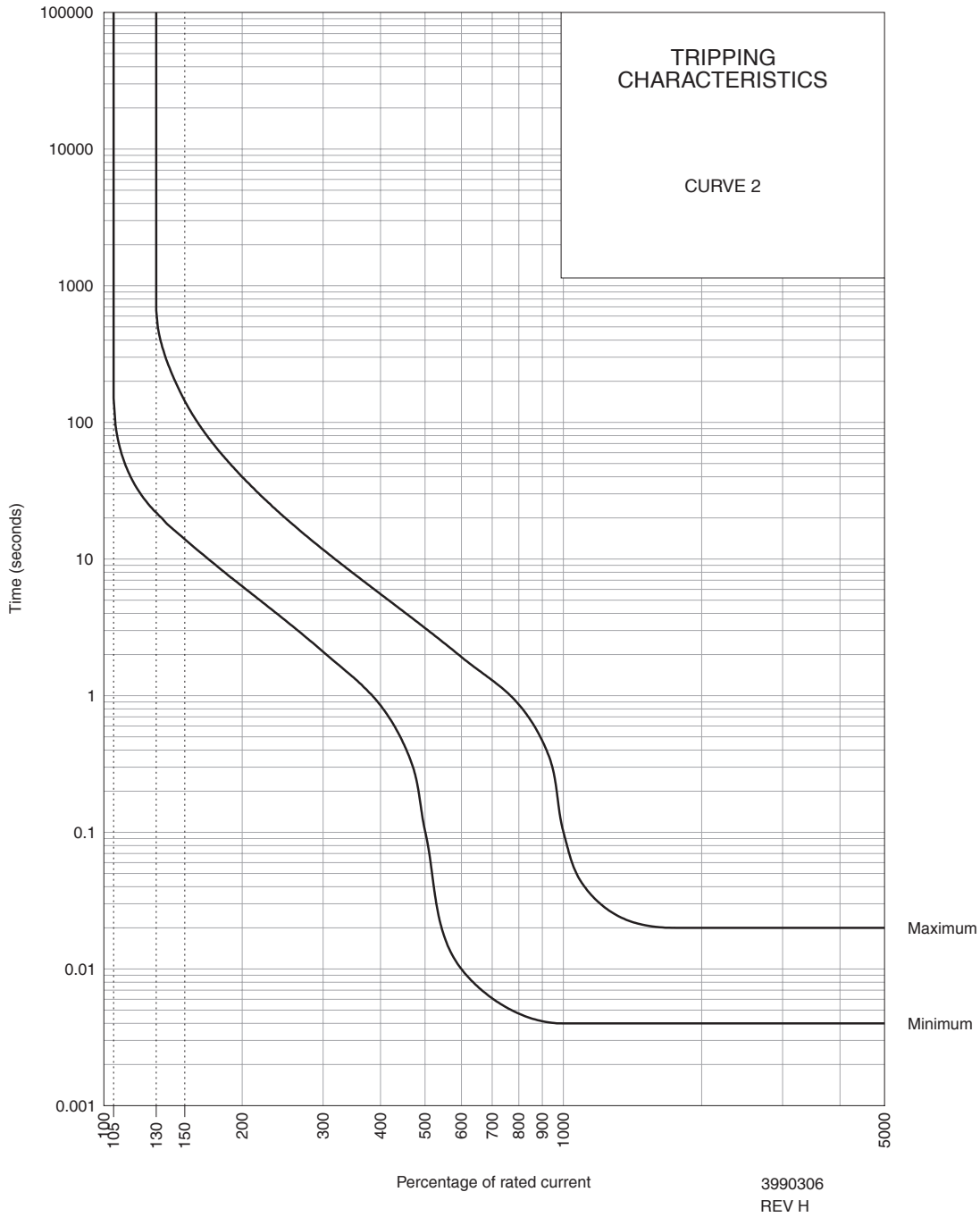

PERCENTAGE OF RATED CURRENT	105%	130%	145%	150%	200%	300%	400%	500%	600%	700%	800%	900%	1000%	2000%
MINIMUM TRIP TIME IN SECONDS	NO TRIP	22	15.4	14	6.3	2.1	0.85	0.1	0.001	0.006	0.005	0.041	0.004	0.004
MAXIMUM TRIP TIME IN SECONDS	NO TRIP	660	180	144	40	12	5.5	3	1.92	1.3	0.86	0.47	0.1	0.02

* The published time delay curves are generated at 30 °C ambient temperature with the circuit breaker mounted in the up-right position. The "must hold", "must trip" and "instantaneous trip" current values are not affected by temperature, although delay time for the other operating current values may have to be adjusted using the temperature compensation curve which is available on request.

QF14 - Series Earth Leakages

Resistance Curve

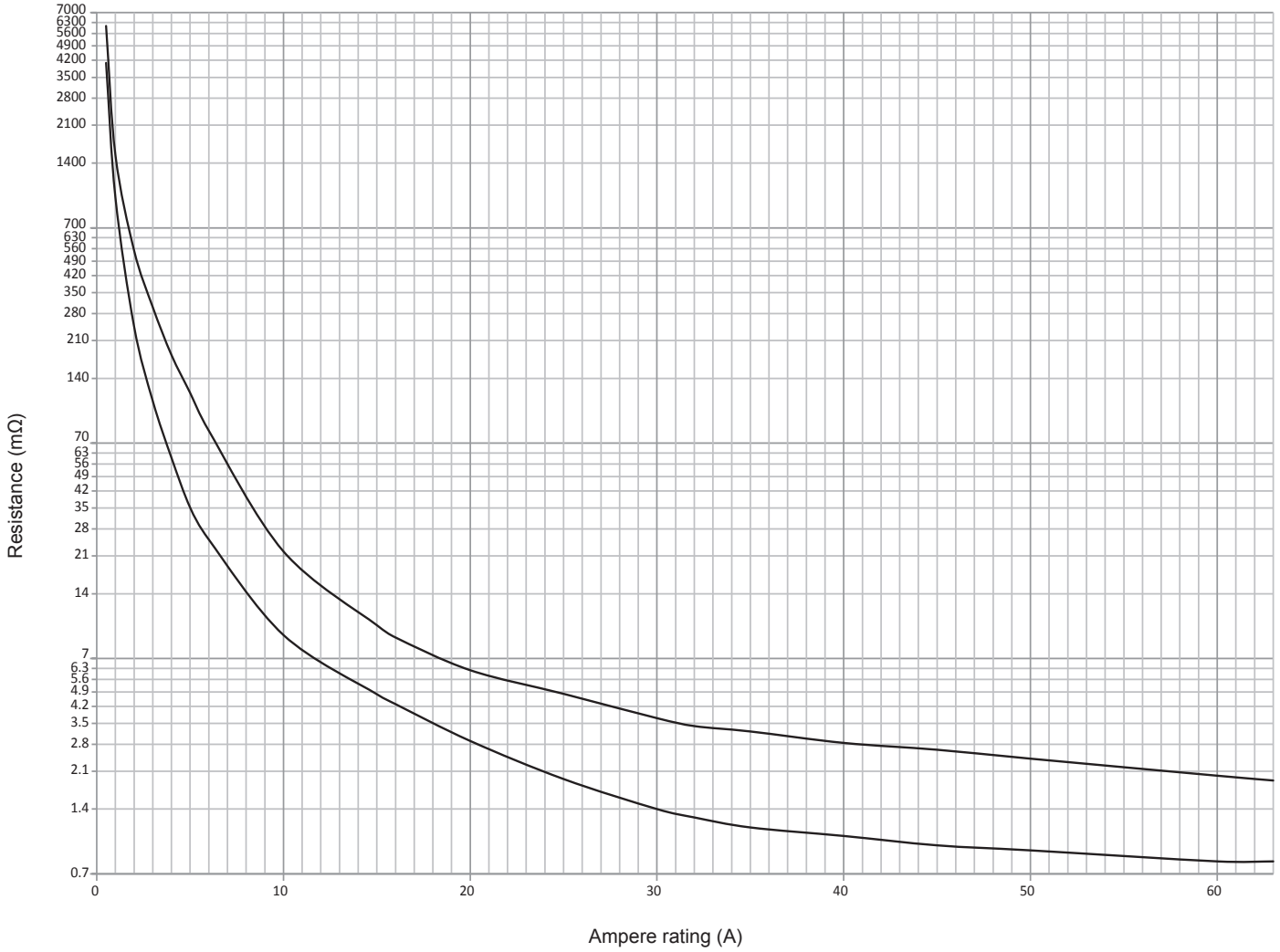

3990A784 REV A

Amp RATING	0.5	1	2	5	6	10	15	20	25	30	32	40	50	60	63
MINIMUM (mΩ)	4085	970	244	35	25	9.0	4.8	2.9	1.9	1.4	1.3	1.1	0.9	0.8	0.8
MAXIMUM (mΩ)	6065	1527	550	120	80	22	10	6.2	4.8	3.7	3.4	2.8	2.4	2.0	1.9

QF14 - Series Earth Leakages

Outline Dimensions: DIN Mount

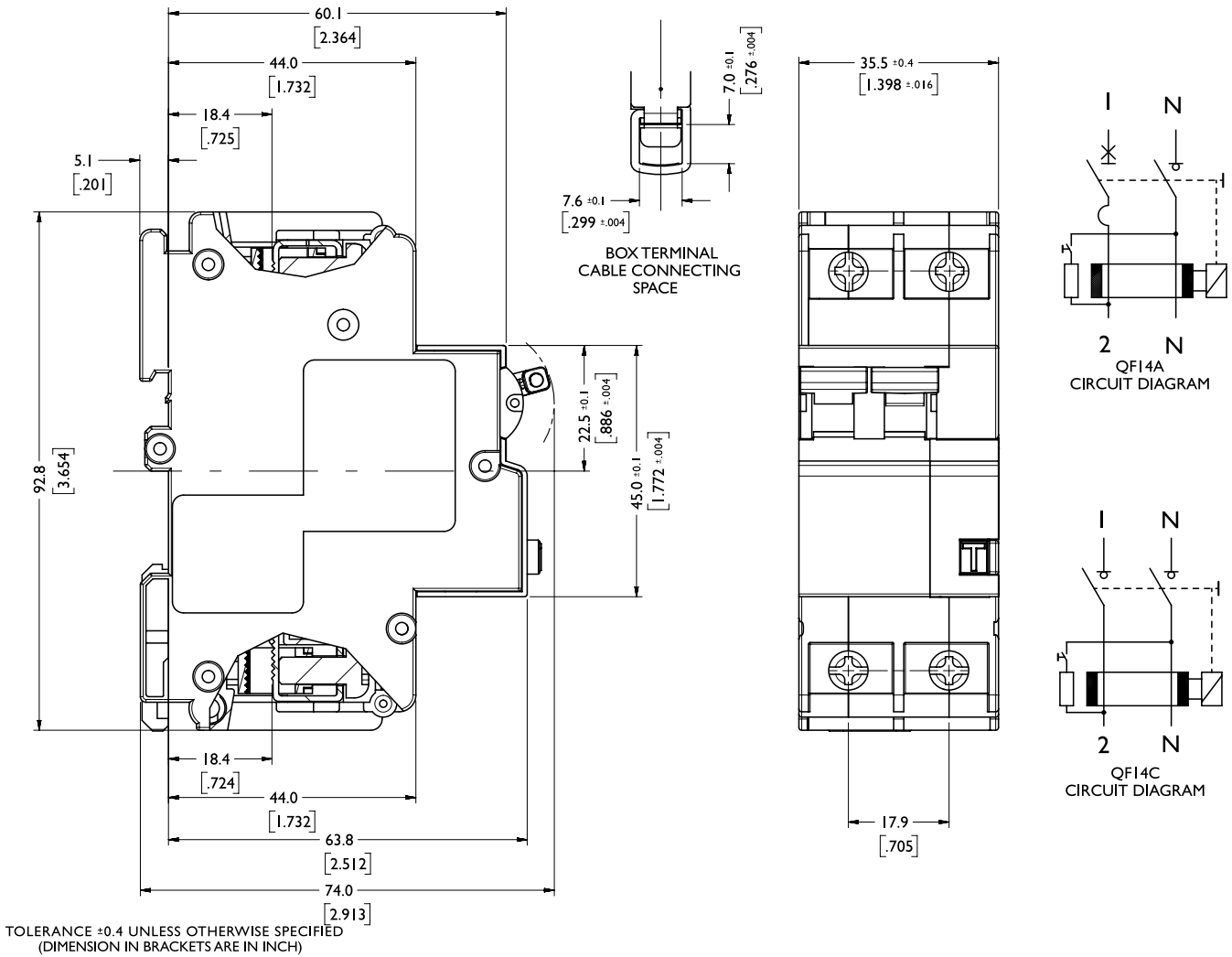

Please review our Customer Terms and Conditions on www.cbi-lowvoltage.co.za

All rights reserved. Unless otherwise indicated, all materials on these pages are copyrighted by CBI (Pty) Ltd. No part of these pages, either text or image may be used for any purpose other than personal use. Therefore, reproduction, modification, storage in a retrieval system or retransmission, in any form or by any means, electronic, mechanical or otherwise, for reasons other than personal use, is strictly prohibited without prior written permission. CBI (Pty) Ltd reserves the right to alter any details of this document without notice and while every effort is made to ensure the accuracy of the content, no warranty is given as to the accuracy of this document and no responsibility will be accepted for error or misinterpretation and any resulting loss.

© CBI (Pty) Ltd. All Rights Reserved.

AUSTRALIA

CBI-electric: Australia
 27 Wedgewood Rd, Hallam
 Victoria 3803 Australia
 Tel: +61 3 8752 9300
 Fax: +61 3 9796 5407
 Email: sales@cbi-electric.com.au
 Website: www.cbi-electric.com.au

INDIA

CBI-electric: Asia
 A1, Pushpagiri Residency, 1st Cross
 2nd Main, Jyothi Nagar, B.G Road
 Bengaluru 560083, India
 Tel: +91-9880553153
 Email: salesasia@cbi-electric.com
 Website: www.cbibreakers.com
 Website: www.cbi-lowvoltage.com

SOUTH AFRICA

CBI-electric: low voltage
 Tripswitch Drive Elandsfontein
 Gauteng South Africa
 Tel: +27 11 928 2000
 Fax: +27 11 392 2354
 Email: cbi@cbi-electric.com
internationalsales@cbi-electric.com
 Website: www.cbi-lowvoltage.com

USA

CBI-electric: North America
 35 E. Uwchlan Ave Suite 328
 Exton PA 19341 USA
 Tel: +1 610 524 9949
 Fax: +1 610 524 9945
 E-mail: info@cbibreakers.com
 Website: www.cbibreakers.com